

RETAIL SPACES FOR LEASE



**GOLDSCHMIDT
& ASSOCIATES**

Commercial Real Estate Group



1953-1955 Palmer Avenue
Larchmont, New York

Property Features

- » 1,890 SF. Can Be Divided
- » Immediate
- » On Site Parking
- » Walk to Larchmont Train Station
- » Own Central HVAC and Electric
- » Near Starbucks, Verizon, Banks, Restaurants
- » Sorry, No Food Uses Permitted

Demographics

	<u>1 Mile</u>	<u>3 Mile</u>	<u>5 Mile</u>
» Population	21,462	126,814	324,462
» Avg HH Income	\$176,825	\$153,232	\$143,519

Asking Rent \$39 PSF NN + \$9.00 PSF Extras

CONTACT

Exclusive Agent:

Eric S. Goldschmidt

Phone: 914-723-1616

Email: eric@ga-re.com

1953-1955 Palmer Avenue Larchmont, NY



1953-1955 Palmer Avenue Larchmont, NY



1953-1955 Palmer Avenue Larchmont, NY

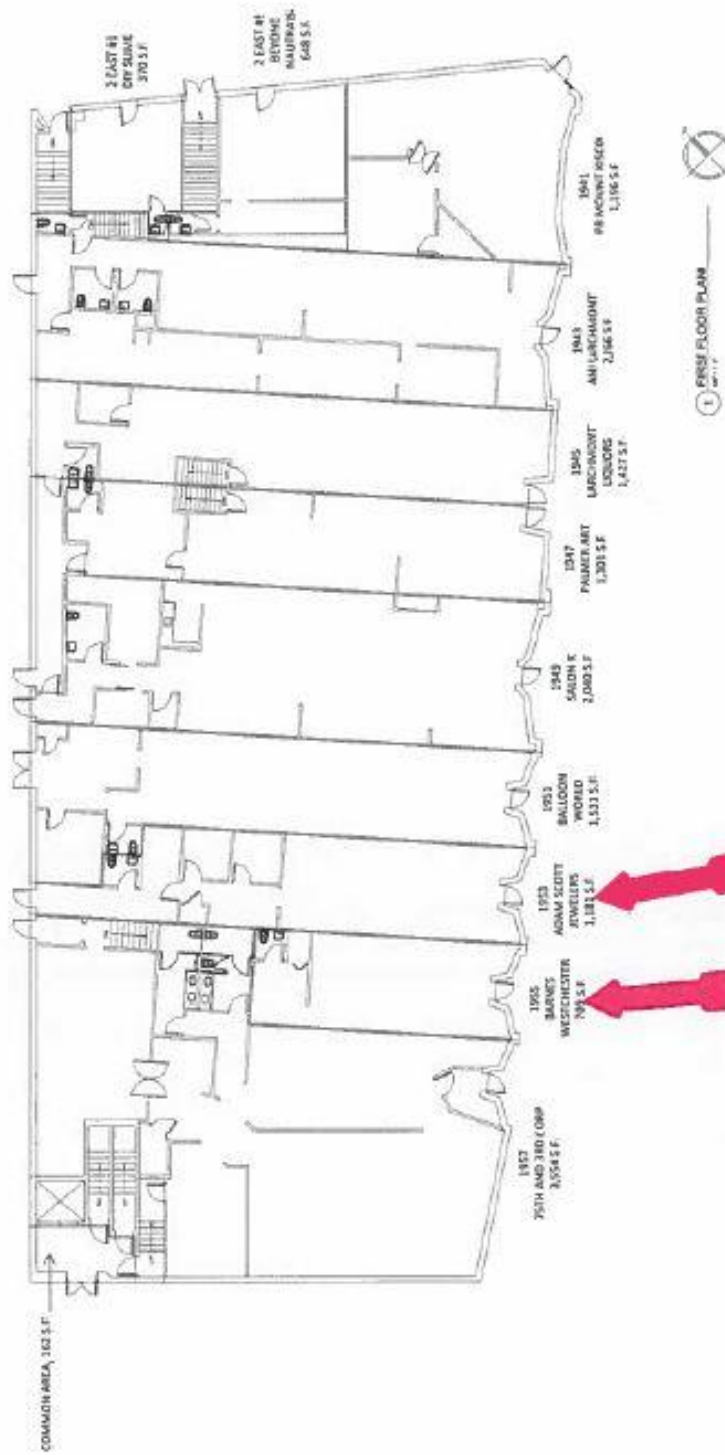

BAR LARCH ASSOCIATES

March 25th, 2025



1953-1955 Palmer Avenue Larchmont, NY

