

RETAIL SPACES FOR LEASE



**GOLDSCHMIDT
& ASSOCIATES**

Commercial Real Estate Group



1953-1955 Palmer Avenue
Larchmont, New York

Property Features

- » 1,885 SF. Can Be Divided
- » Immediate
- » On Site Parking
- » Walk to Larchmont Train Station
- » Own Central HVAC and Electric
- » Near Starbucks, Verizon, Banks, Restaurants
- » Sorry, No Food Uses Permitted

Demographics

» Population

1 Mile

21,462

3 Mile

126,814

5 Mile

324,462

» Avg HH Income

\$176,825

\$153,232

\$143,519

Asking Rent \$39 PSF NN + \$7.50 PSF Extras

CONTACT

Exclusive Agent:

Eric S. Goldschmidt

Phone: 914-723-1616

Email: eric@ga-re.com

1953-1955 Palmer Avenue Larchmont, NY



1953-1955 Palmer Avenue Larchmont, NY



1953-1955 Palmer Avenue Larchmont, NY

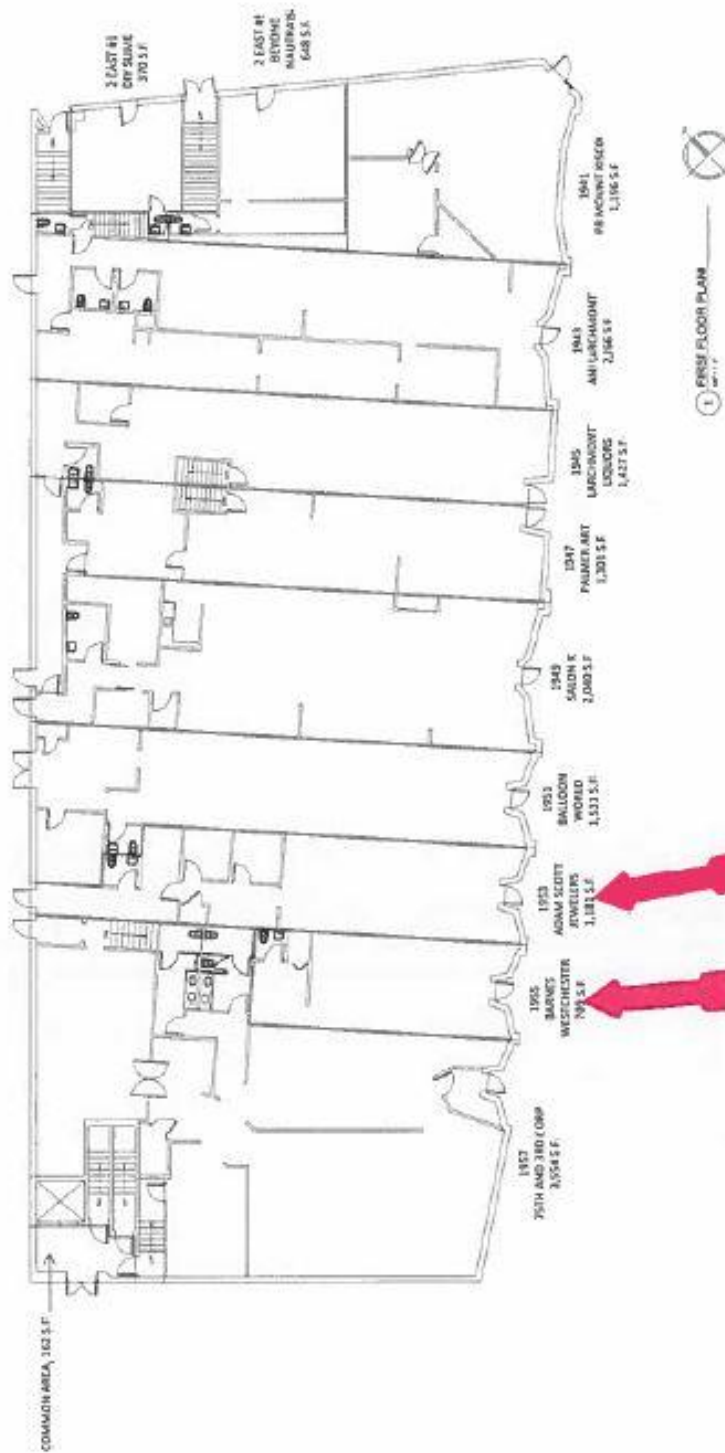

BAR LARCH ASSOCIATES

March 25th, 2025



1953-1955 Palmer Avenue Larchmont, NY

